

Pre-assembled storm shelter control panel for tornado shelter and emergency control applications. Two independent control zones each include an illuminated momentary START pushbutton, key-reset operator, contactor output, and device-status LED indicator. NEMA 4X polycarbonate enclosure (IP66/IP67), UL 508A listed, made in the USA.

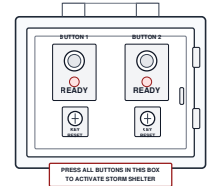

KEY FEATURES

- ✓ NEMA 4X / IP66 / IP67 polycarbonate enclosure — corrosion-resistant, wet/dusty location rated
- ✓ Two independent control zones — Zone 1: Ventilation Fan + Relief Damper, Zone 2: Gas Shutoff
- ✓ Illuminated momentary START pushbutton per zone — button stays lit while zone is active
- ✓ Key-reset override per zone — inserting key and turning opens contactor, light turns off
- ✓ Contactor-controlled output per zone — interfaces with fan motor starter or access control system
- ✓ Device-status READY LED per zone — illuminates when controlled device confirms operational status
- ✓ UL 508A listed — certified for industrial control panel applications
- ✓ BAA compliant — made in the USA

SPECIFICATIONS

Control Zones	2 independent
Zone 1 Function	Ventilation Fan + Relief Damper control
Zone 2 Function	Gas Shutoff (access control system interface)
Pushbutton Type (Zone 1)	Illuminated momentary START with keyed reset
Pushbutton Type (Zone 2)	Illuminated momentary START with keyed reset
Indicator Light	Red LED, confirms device operational status (READY)
Contactor	3-Pole, 60A, 120V coil, electrically held
Control Voltage	120VAC single-phase
Enclosure Rating	NEMA 4X / IP66 / IP67
Enclosure Material	Polycarbonate, UV-resistant
Enclosure Dimensions	18 H x 16 W x 10 D in
Mounting	Surface wall mount
Enclosure Color	Gray, RAL 7035
Conduit Entries	Top entry, 1 in conduit
Certifications	UL 508A listed
Ambient Temperature	-40°F to +131°F
Wire Size (Load)	14-8 AWG copper
Wire Size (Control)	18-14 AWG
BAA Compliant	Yes — made in the USA

INSTALLATION NOTES

- Install enclosure bottom at 44 in AFF (above finished floor)
- Zone 1 (Ventilation): wire pushbutton to contactor coil; contactor output interfaces with fan motor starter; parallel BMCS connection
- Zone 2 (Gas Shutoff): wire pushbutton to contactor coil; contactor output interfaces with access control system for gas valve actuator
- READY LED receives status signal from controlled device via BMCS or auxiliary contact
- Key-reset operator opens contactor for emergency stop or maintenance isolation
- Route control wiring through conduit entries at top; coordinate conduit routing with architect

ORDERING INFORMATION

Part Number	Description
CTRL-PNL-STRMSHLTR-2Z-120V	Storm Shelter Control Panel, 2 Control Zones, 120VAC, NEMA 4X Enclosure

UL 508A Listed

NEMA 4X Enclosure

IP66 / IP67

BAA Compliant